

AL-160・160L

Features

1. Versatile type, compatible with fluids such as steam, air, water, and oil.
2. Popping structure ensures reliable discharge.
3. The AL-160L is lift lever type, and a discharge inspection can be manually performed on the valve at more than 75% of opening pressure.
4. The trim parts (valve and valve seat) are made of stainless steel. Used for the trim parts is SCS14A (equivalent to SUS316) with outstanding corrosion resistance.
5. Advanced technology, high-quality materials and a simple structure ensure easy maintenance and inspections and astonishing durability.

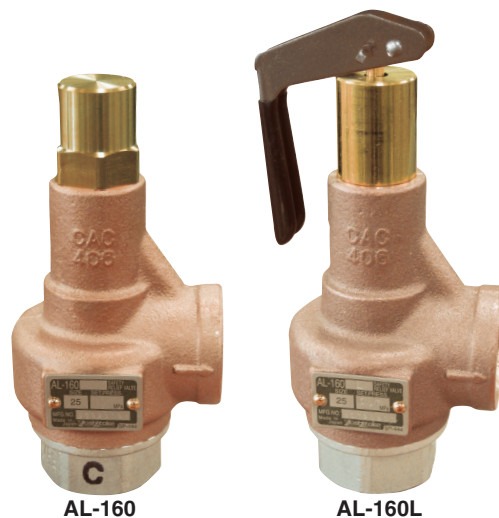

Specifications

Model	AL-160	AL-160L
Structure	Closed type	Open type with a lever
Application	Steam, Air, Water, Oil, Non-dangerous fluids	Steam, Air
Working pressure	0.05-1.0 MPa	
Maximum temperature	220°C *	220°C
Material	Spring case	Cast bronze
	Valve, valve seat	Cast stainless steel (SCS14A)
Connection	JIS Rc screwed	

* The maximum temperature is 150°C when using for water, oil, or other liquids.

Dimensions and Weights

●AL-160

Nominal size	Dimension (mm)					Flow area $\pi D \ell$ (mm ²)	Weight (kg)
	d	L	H ₁	H	Seat diameter		
15A	Rc 1/2	34	40	126	16	20.1	0.7
20A	Rc 3/4	38	43	126.5	21	34.6	0.8
25A	Rc 1	43	51.5	142.5	26	53.0	1.1
32A	Rc 1-1/4	50	61.5	179.5	33	93.3	1.8
40A	Rc 1-1/2	60	60	203	41	135.2	2.8
50A	Rc 2	75	76	243.5	51	208.2	4.7

●AL-160L

Nominal size	Dimension (mm)					Flow area $\pi D \ell$ (mm ²)	Weight (kg)
	d	L	H ₁	H	Seat diameter		
15A	Rc 1/2	34	40	148	16	20.1	0.8
20A	Rc 3/4	38	43	148	21	34.6	0.9
25A	Rc 1	43	51.5	165	26	53.0	1.2
32A	Rc 1-1/4	50	61.5	201	33	93.3	1.9
40A	Rc 1-1/2	60	60	226	41	135.2	2.9
50A	Rc 2	75	76	266	51	208.2	4.8

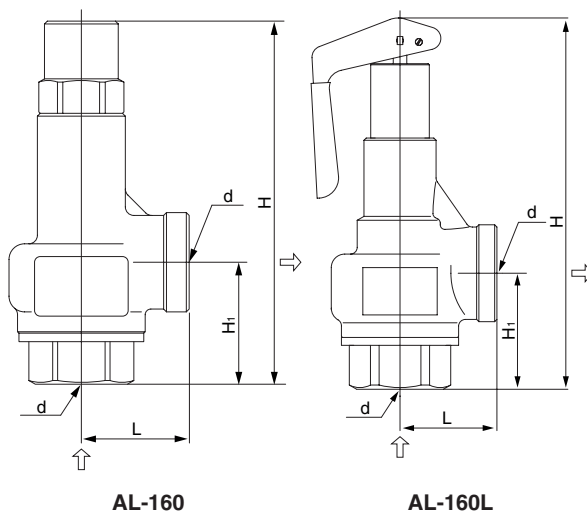

AL-160

AL-160L

010-59799400

<http://www.yoshitake-bj.com/>